

C13 Series

Micro Vacuum Pump



Datasheet



Highlights

- Low power consumption
- Allowed to work under max load
- Support voltage speed control
- Low noise level and vibration
- Industrial-grade reliability
- Good air tightness
- Cost-effective
- Compact size

Applications

- Gas sampling
- Medical equipment
- Analytical Instruments
- Portable devices

400 hours
lifetime test



PERFORMANCE DATA

Model	Voltage (V DC)	Max. Load Current (mA)	Max. Peak Flow rate (L/min)	Max. Average Flow rate (L/min)	Max. Vacuum (-kPa)		
Material Option A	Diaphragm:EPDM Valves:EPDM Pump Head: Fiber reinforced PA6						
C13L	5V	≤240mA	≥0.4	≥0.3	≥18		

Note: The rated voltage of the product is 5V, and the load current is measured under the rated voltage. The product can work in the input voltage range of 3.7V to 6V.

CONFIGURATION OPTIONS

Material Options

Pump Head	Fiber reinforced PA6
Diaphragm	EPDM
Valves	EPDM
Motor	BDC motor

RELIABILITY DATA

Models	C13L	
Fully Loaded Lifetime (hrs)	400	
Unloaded Lifetime (hrs)	600	
Motor Lifetime (hrs)	900	
Test conditions	In a clean and non-corrosive laboratory, the pump is fully loaded (the outlet is blocked, the inlet is directly connected to the atmosphere) or unloaded (the inlet and outlet are directly connected to the atmosphere), and runs continuously around the clock; ambient temperature: 5°C~33 °C, relative humidity: 50%-85%, fluctuates with the climate.	
Working Condition		
Operating temperature	Permissible ambient temperature is 0°C~50°C, it is not suitable to be exposed to the sun, and it should work in a clean and ventilated environmen	
Medium	Permissible temperature of the medium is 5°C~50°C, the transferring gas is allowed to be rich in water vapor, but cannot contain solid particles	
Wetted materials	EPDM, FKM as optional; fiber reinforced nylon, tolerance to alcohol, acid, alkali, etc. (except strong acid, concentrated acid, lipids, benzene, gasoline, etc.)	

C13 SERIES DIMENSIONS

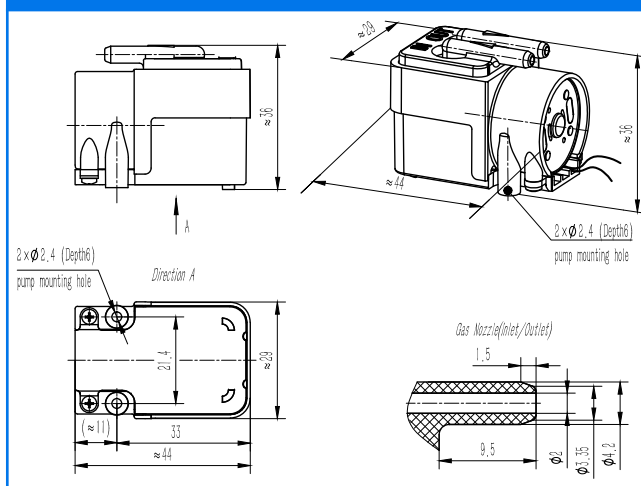

C13 MODEL KEY

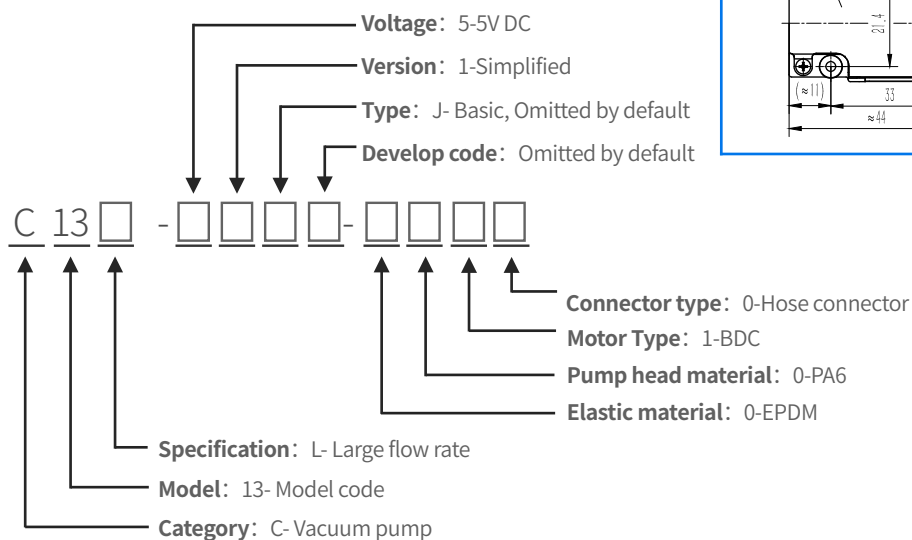

ACCESSORIES		
Descriptions	Illustration	Function
Shock-isolation mounting feet		Reduce the impact of vibration on the equipment during the operation of the pump. This accessory comes with the pump*4
Filter		The 80-mesh filter protect both pumps and other upstream instrumentation and hydraulic circuits against particulate, crystals and fibers . It is recommended to replace it regularly. This accessory comes with the pump*1
Check valve		Enhance the cut-off capability of the gas circuit system to ensure one-way gas flow. This accessory can be purchased on demand
Flow stabilizer		Eliminate and reduce pulsation, make gas output smooth and stable, this accessory can be purchased on demand
Manul control valve		It can be used to manually adjust the gas flow rate, pressure and vacuum. This accessory can be purchased on demand
Power Adapter		220V AC to DC switching power supply, this accessory can be purchased on demand
Silencer		It is used to eliminate and reduce the airflow noise caused by pumping operation, this accessory can be purchased on demand



To be a driving force in innovation of human fluid technology

Create value for customers by offering high quality fluid solutions

This document is for reference only and does not constitute any promise or guarantee. The parameters and experimental data indicated in this document come from Hilintec life and aging laboratory and supplier laboratories. In the actual user system, due to differences in actual usage conditions and experimental conditions, relevant value will change accordingly. Due to product improvement needs, the parameters may be adjusted without notice. Please contact the manufacturer or agent for confirmation before purchasing. The trademarks, pictures, and logos in this document are owned by Chengdu Hailin Technology Co., Ltd. or a third party with legal rights.

Hilintec®

www.mini-pump.com